

Valvola a sfera sanitaria manuale
Manual sanitary ball valve

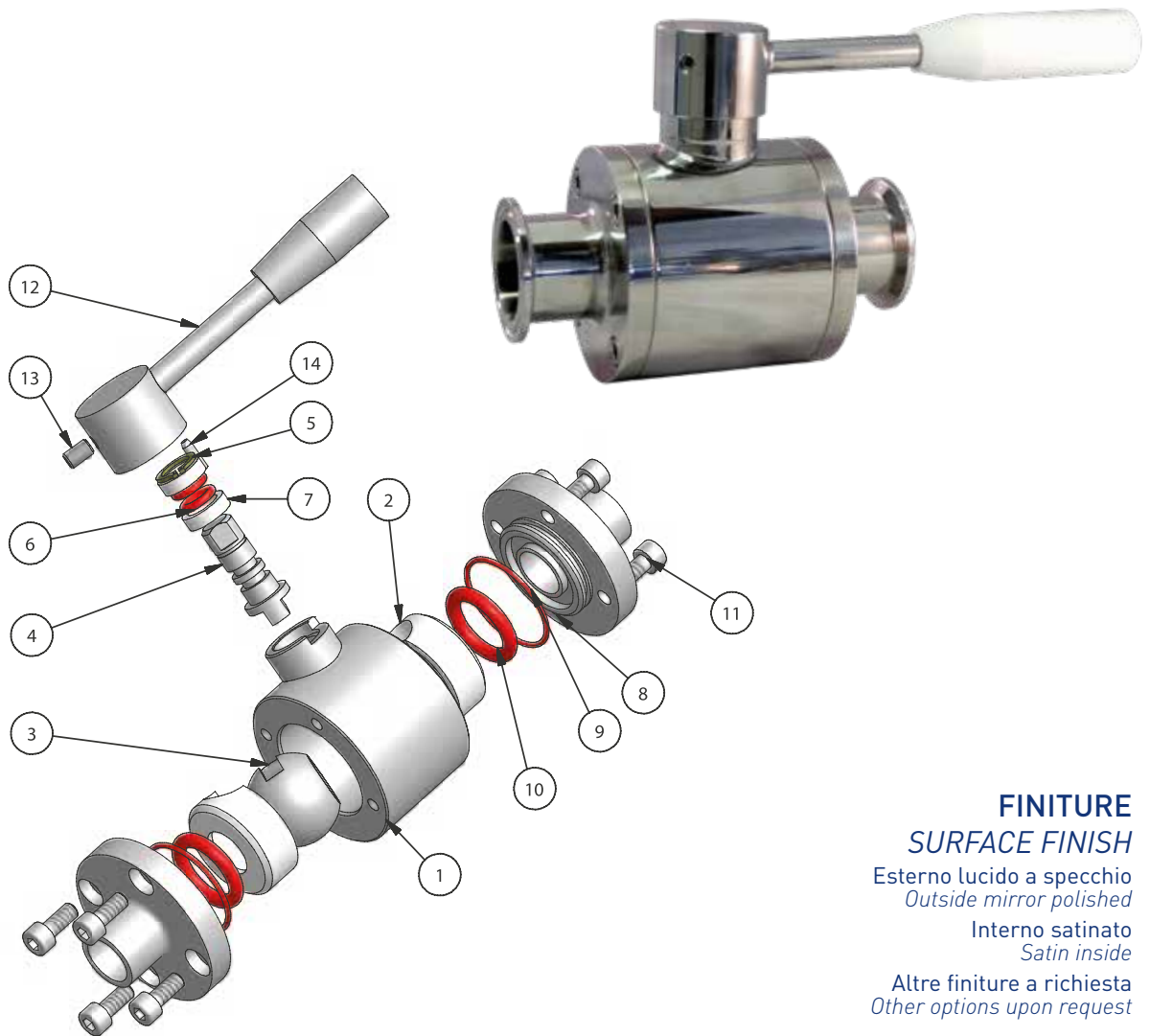



FINITURE

SURFACE FINISH

Esterno lucido a specchio
Outside mirror polished

Interno satinato
Satin inside

Altre finiture a richiesta
Other options upon request

SIZE RANGE

1/2" - 6"

Elenco parti / Parts list			
elemento element	qtà quantity	descrizione description	materiale material
1	1	Corpo / Body	AISI 316 L
2	2	Seggio / Seat	TFM 1705PTFE
3	1	Sfera / Ball	AISI 316 L
4	1	Perno / Pin	AISI 316 L
5	1	Seeger	INOX A2
6	2	Guarnizione OR / O ring	Silicone/Viton...
7	2	Distanziale PTFE / PTFE Washer	Teflon
8	2	Testata / External Body	AISI 316 L
9	2	Guarnizione OR / O ring	Silicone/Viton...
10	2	Guarnizione OR / O ring	Silicone/Viton...
11	8	Vite TCEI / TCEI Screw	INOX A2
12	1	Maniglia / Handle	AISI 304
13	1	Grano / Screw	INOX A2
14	1	Spina / Pin	INOX A2

*Materiale in alternativa 1.4435

*Material alternatively 1.4435

PRESSIONE NOMINALE

PRESSURE

PN 40

TEMPERATURA DI ESERCIZIO

TEMPERATURE RANGE

-20°C / +160°C

CONNESSIONI

CONNECTIONS

Clamp BS 4825

Attacco filettato F/F

Thread connection 11850

Attacco a saldare DIN

DIN weld connection 11850

Attacco clamp a saldare

Clamp weld connection BS

Attacco flangiato PN 6 / 16

Flanged connection PN 6 / 16

Altre esecuzioni a richiesta

Other options upon request

Ø	1/2"	3/4"	1"	1"1/2	2"	2"1/2	3"	4"	6"
L	88	88	110	145	147	164	176	215	274
E	9.8	16	22.1	34.8	47.5	60.2	72.6	97.6	147
M	95	95	155	185	185	240	240	235	400

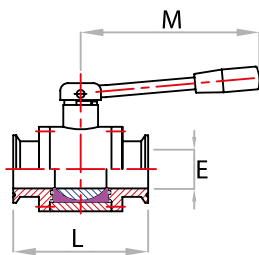

COD. VSSTC...-6

Attacco Clamp BS4825
Clamp Connection
BS4825

DN	15	25	40	50	65	80	100
L	88	120	145	155	190	194	240
E	15	25	39	50	66	81	101
M	95	155	185	185	240	240	240

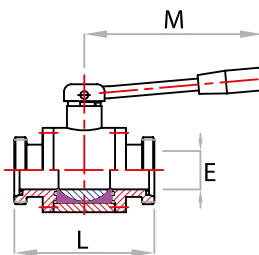

COD. VSSD...FF-6

Attacco DIN 11851 F/F
Thread Connection
DIN 11851 F/F

DN	15	25	40	50	65	80	100	150
L	84	110	145	160	180	190	220	274
E	15	25	36	48	66	81	97	150
M	95	155	185	185	240	240	235	400

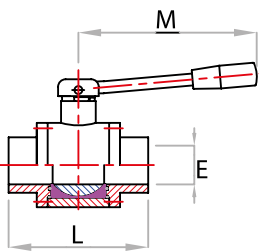

COD. VSSD...SS-6

Attacco a saldare DIN
Weld Connection
DIN 11850

DN	15	25	40	50	65	80	100
L	130	180	190	230	250	310	330
E	15	25	39	49	65	75	98
M	95	155	185	185	240	240	235

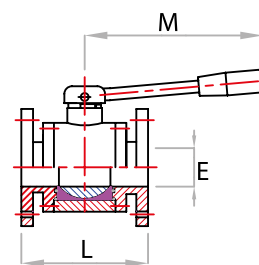

COD. VSS...FL/FL-PN16-6

Attacco flangiato PN 16
Flanged connection PN 16

Esecuzioni speciali a richiesta
Special execution available on request

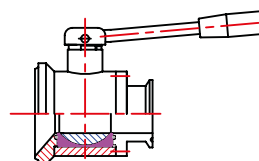

COD. VSS...FL/FL-PN6-6

Attacco flangiato PN 6
Flanged connection PN 6

Valvola a sfera sanitaria
Sanitary ball valve



CONNESSIONI

CONNECTIONS

Clamp BS 4825

Attacco filettato F/F
Thread connection 11850

Attacco a saldare DIN
DIN weld connection 11850

Attacco clamp a saldare
Clamp weld connection BS

Attacco flangiato PN 6 / 16
Flanged connection PN 6 / 16

Altre esecuzioni a richiesta
Other options upon request



FINITURE

SURFACE FINISH

Esterno lucido a specchio
Outside mirror polished

Interno satinato
Satin inside

Altre finiture a richiesta
Other options upon request

SIZE RANGE

1/2" - 6"

PRESSIONE NOMINALE

NOMINAL PRESSURE

PN40

TEMPERATURA DI ESERCIZIO

TEMPERATURE RANGE

-20°C / +160°C

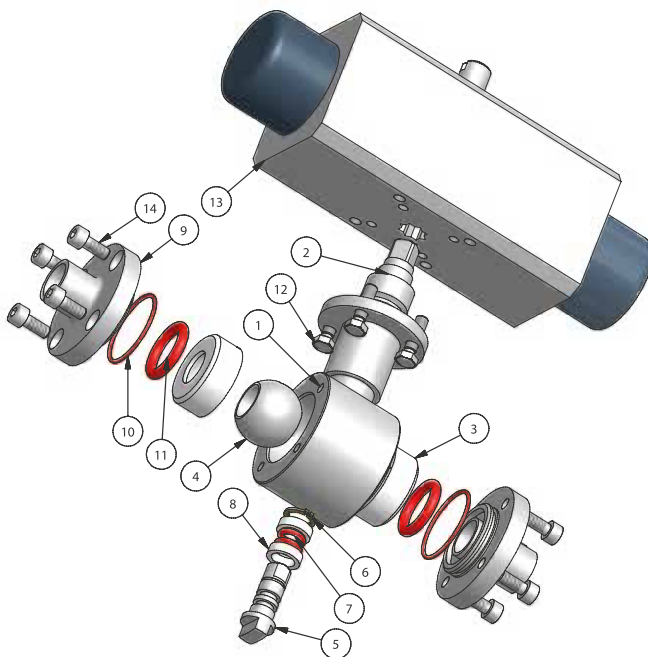

Elenco parti / Parts list			
Elemento Element	Qtà Quantity	Descrizione Description	Materiale Material
1	1	Corpo / Body	AISI 316 L
2	1	Perno attuatore / Actuator Pin	AISI 303
3	2	Seggio / Seat	TFM 1705 PTFE
4	1	Sfera / Ball	AISI 316 L
5	1	Perno / Pin	AISI 316 L
6	1	Seeger / Seeger Ring	INOX A2
7	2	Guarnizione OR / O ring	VITON
8	2	Distanziale / PTFE washer	TEFLON
9	2	Testata / External body	AISI 316 L*
10	2	Guarnizione OR / O ring	VITON
11	2	Guarnizione OR / O ring	VITON
12	4	Vite TE / Screw M5 x 18	INOX A2
13	1	Attuatore pneum. / Pneu. actuator	
14	8	Vite TCEI / TCEI screw	INOX A2

*Materiale in alternativa 1.4435

*Material alternatively 1.4435

**ATTUATORE PNEUMATICO
VERTICALE INOX
STAINLESS VERTICAL
PNEUMATIC ACTUATORS**

con box di segnalazione finecorsa induttivi/
prossimità/atex
*with box and optical indicator of proxy or
mechanical limit atex switches*



**ATTUATORE PNEUMATICO SEMPLICE
EFFETTO "SR"
PNEUMATIC ACTUATOR SIMPLE
EFFECT "SR"**

con finecorsa di prossimità
with proxymity limit switches



**ATTUATORE PNEUMATICO
SEMPLICE EFFETTO "SR"
PNEUMATIC ACTUATOR
SIMPLE EFFECT "SR"**

con box di segnalazione e indicatore
visivo di posizione
*mechanical switches box with optical
indicator*

Valvola a sfera manuale
Manual ball valve

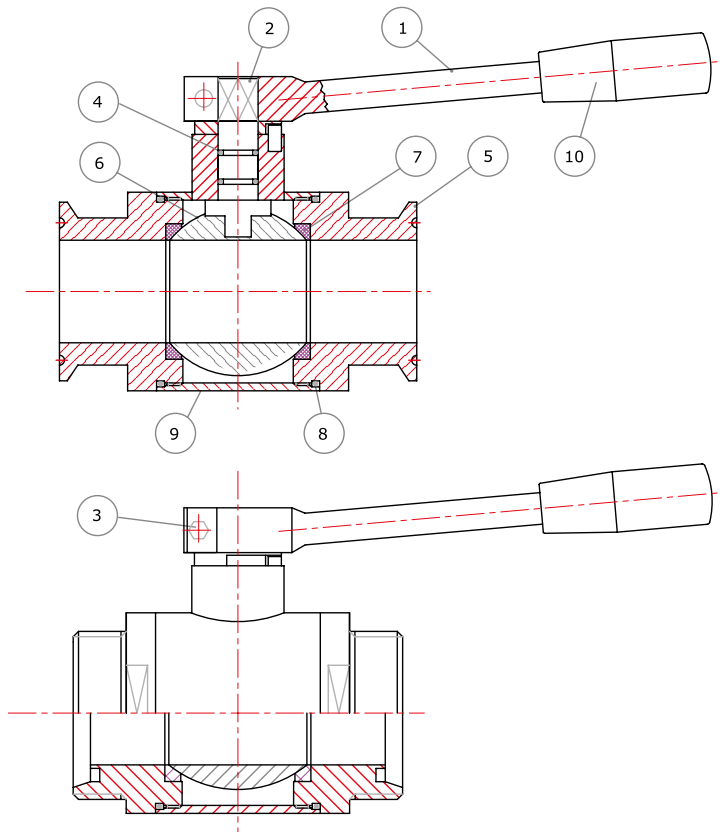

pos	descrizione / description	materiale / material
1	Maniglia / Handle	AISI 304
2	Perno / Pin	316 L
3	Vite / Pin	AISI 304
4	O Ring	N.B.R.
5	Attacco / Connection	316 L*
6	Sfera / Ball	316 L
7	Guarnizione / Seal Ring	P.T.F.E.
8	O Ring	N.B.R.
9	Corpo / Casing	AISI 304/316 L
10	Impugnatura / Handle	Termoindurente Thermo hardener

*Materiale in alternativa 1.4435

*Material alternatively 1.4435

FINITURE

SURFACE FINISH

Esterno lucido a specchio
Outside mirror polished

Interno satinato
Satin inside

Altre finiture a richiesta
Other options upon request

SIZE RANGE

1/2" - 4"

PRESSIONE NOMINALE

NOMINAL PRESSURE

PN 16

TEMPERATURA ESERCIZIO

TEMPERATURE

-20°C / +100°C



dn	3/4"	1"	1"1/2	2"	2"1/2	3"	4"
E	25	50	50	64	77,4	90	119
I	16	25	33	48,5	60	75	98
L	88	95	110	138	186	185	215
H	47	60	70	86	100	105	140
M	93	124	142	185	185	240	240

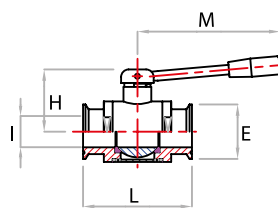

COD. VSTC...-4/6

Attacco clamp
Clamp connection
BS 4825

dn	15	20	25	32	40	50	65	80	100
E	34	44	52	58	65	78	95	110	130
I	15	20	25	33	39	48,5	65	75	98
L	84	99	102	114	124	138	170	181	204
H	47	57	60	70	80	86	100	105	140
M	93	124	124	142	185	185	240	240	235

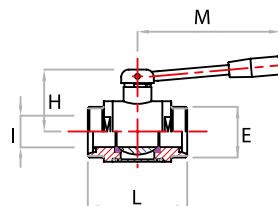

COD. VSD...FF-4/6

Attacco filettato DIN
DIN Thread connection

dn	15	20	25	32	40	50	65	80	100
E	18	22	28	34	40	52	70	85	104
I	15	19	25	11	37	48,5	66	75	98
L	87	95	100	118	131	147	176	180	220
H	47	57	60	70	80	86	100	105	140
M	93	124	124	142	185	185	240	240	235

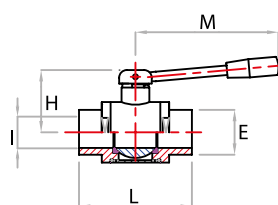

COD. VSD...SS-4/6

Attacco a saldare DIN
DIN Weld connection

dn	25	32	40	50	65	80	100
E	52	58	65	78	95	110	130
I	24,5	33	39	48,5	65	75	98
L	117	132	142	160	198	211	249
H	60	70	80	86	100	105	140
M	93	124	124	142	185	185	240

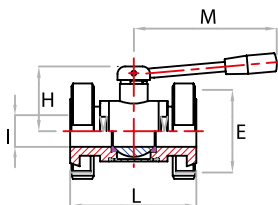

COD. VSD...MG/MG-4/6

Attacco maschio Gir. DIN
Round nut connection

dn	3/8"	1/2"	3/4"	1"	1"1/4	1"1/2"	2"	2"1/2	3"	4"
E	16,6	21	26,4	33,2	41,9	47,6	59,6	75,1	87,8	113
I	15	15	20	24,5	33	39	48,5	65	75	98
L	60	60	69	76	94	102	116	148	153	185
H	47	47	57	60	70	80	86	100	105	140
M	90	93	124	124	142	185	185	240	240	235

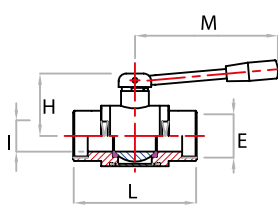

COD. VSG...FF-4/6

Attacco filettato Gas F.
UNI 338 thread connection

dn	20	25	32	40	50	65	80	100
E	90	100	120	130	140	160	190	210
I	20	24,5	33	39	48,5	65	75	98
L	95	100	118	131	147	176	187	330
H	69	72	70	80	86	100	105	140
M	95	110	138	134	160	180	187	240

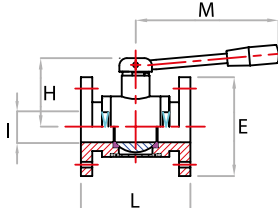

COD. VSD...FL-4/6

Attacco flangiato PN 6
Flanged connection PN 6

Valvola a sfera manuale
Manual ball valve



COD. VS3VTC...T/L-6

Attacco clamp
Clamp connection

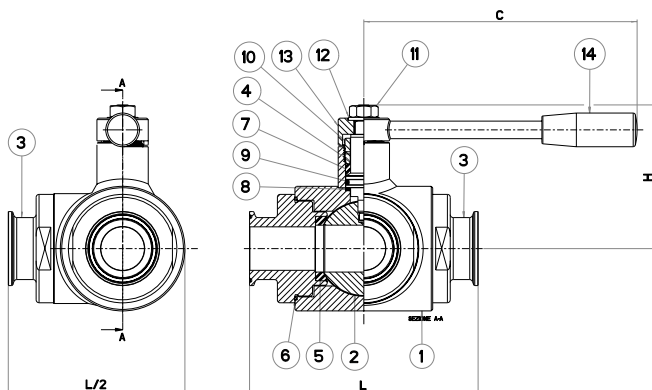

COD. VS3VDN...F-T/L-6

Attacco filettato DIN
DIN thread connection

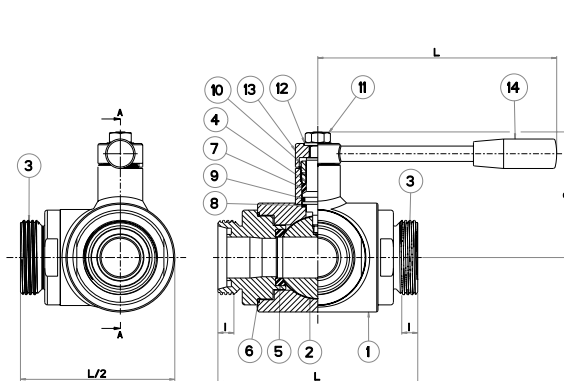

CLAMP	DN	L	øA	øB	C	H	PN	Kg. "T"	Kg. "L"
1/2"	10	108	25	9.7	110	60	40	1.08	1.08
3/4"	15	118	25	16	110	65	40	1.30	1.31
1"	20	130	50.5	22.2	160	70	40	2.45	2.47
1"	25	140	50.5	22.2	160	80	40	3.13	3.17
1 1/2"	32	156	50.5	34.8	190	95	40	4.90	4.98
1 1/2"	40	172	50.5	34.8	190	110	40	7.25	7.40
2"	50	182	64	47.5	235	120	25	8.60	8.80
2 1/2"	65	196	77.5	60.2	285	130	25	10.70	11.18
3"	80	256	91	72.6	310	145	16	22.11	22.76
4"	100	286	119	97.6	310	160	16	34.97	35.44

*4vie

DN	Rd	L	I	C	H	PN	Kg. "T"	Kg. "L"
10	28X1/8"	108	12	110	60	40	1.08	1.10
15	34X1/8"	118	12	110	65	40	1.44	1.45
20	44X1/6"	130	14	160	70	40	2.27	2.30
25	52X1/6"	140	14	160	80	40	3.04	3.07
32	58X1/6"	156	14	190	95	40	5.07	5.15
40	65X1/6"	172	14	190	110	40	7.42	7.56
50	78X1/6"	182	14	235	120	25	9.01	9.20
65*	95X1/6"	196	16	285	130	25	10.95	11.27
80*	110X1/4"	256	20	310	145	16	22.40	23.05
100*	130X1/4"	286	20	310	160	16	35.00	36.16

*4vie

FINITURE

SURFACE FINISH

Esterno lucido
Outside polished

Interno a richiesta
Inside upon request

TEMP. ESERCIZIO

TEMPERATURE RANGE

-20°C / +160°C

TENUTA

PTFE sealing

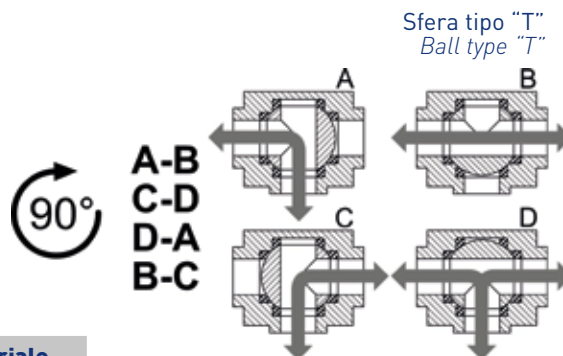

Sfera tipo "T"
Ball type "T"

Elemento Element	Descrizione Description	Qtà Quantity	Materiale Material
1	Corpo / Body	1	AISI 316L
2	Sfera / Ball	1	AISI 316L
3	Maniglia / Handle	3	AISI 316L
4	Perno / Pin	1	AISI 316L
5	Guarnizioni sfera / Seat ball	4	PTFE
6	O ring	3	PTFE
7	Guarnizione perno / Pin gasket	1	PTFE
8	Guarnizione perno / Pin gasket	1	PTFE
9	O ring	1	FKM
10	Ghiera di registro / Stop ferrule	1	AISI 304L (303)
11	Dado / nut	1	AISI 304L
12	Rondella / Flat washer	1	AISI 304L
13	Leva / Lever	1	AISI 304L
14	Impugnatura / Handle	1	Resina

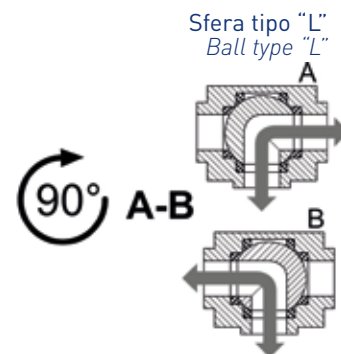

Sfera tipo "L"
Ball type "L"

Disponibile anche
in versione pneumatica
Also available in pneumatic version